

# Stop guide

Next services information

Visit [transportsw.info](http://transportsw.info) or scan this QR code for next services information



## Transport connections

- L** L2 Randwick Line and L3 Kingsford Line services operate Monday to Sunday 05:00 to 01:00  
From 7.00am to 7.00pm weekdays, services operate every 4 minutes between Circular Quay and Moore Park, and every 8 minutes between Moore Park and Randwick or Juniors Kingsford.
- T** Train services depart from Circular Quay for T2, T3, T8 lines, including services to the Airport.
- B** Bus services depart from Circular Quay Bus Interchange, Bus services operate to the Eastern Suburbs, Inner South, Inner West and Victoria Road, as well as towards Parramatta.
- i** For details of these services refer to the Find your way information points marked on the Local area map below.  
For more details of other bus stops nearby, visit [transportsw.info](http://transportsw.info)

- F** Ferry services depart from Circular Quay for travel around Sydney Harbour.
- Private ferry services and cruises** depart from Circular Quay wharves 2 and 6, the Commissioners Steps and Opera Quays for travel around Sydney Harbour. Further details are provided at these wharves.
- Taxi ranks** are located on Argyle St in The Rocks and on Pitt St.
- Bike parking spaces** are located in this area. For locations refer to the Local area map below.

## Customer assistance

- Emergency HELP** Emergency Help Points link directly to staff who can assist you. Penalties may apply for misuse of Emergency Help Points.
- Hearing loops** This stop is equipped with hearing loops below the shelter canopy and in coverage areas as shown on the Stop map below. Use a T-Switch hearing aid to more easily hear customer announcements.
- Lost items** To report lost items visit [transdesydney.com.au](http://transdesydney.com.au) or call 02 8584 5288, Monday to Friday 08:30 to 17:00 (excluding public holidays). For hearing or speech impairments, please contact the National Relay Service on 133 677 or visit [relayservice.gov.au](http://relayservice.gov.au)

## Tickets

- Light rail services** you can use an Opal card, a contactless credit or debit card or a linked device to pay for travel by tapping on and tapping off at the Opal readers on each platform.
- Plan ahead and top up** or purchase your Opal card online or from an Opal retailer. Visit [transportsw.info](http://transportsw.info) for more information.
- Tap on and tap off, every time.** Remember to both tap on and tap off to avoid a fine of up to \$550.00.

## Destinations

- 1 Overseas Passenger Terminal
- 2 Sydney Opera House
- 3 Sydney Harbour Bridge
- 4 Barangaroo Reserve
- 5 The Rocks
- 6 Sydney Observatory
- 7 Museum of Contemporary Art
- 8 Customs House
- 9 Museum of Sydney
- 10 Royal Botanic Gardens

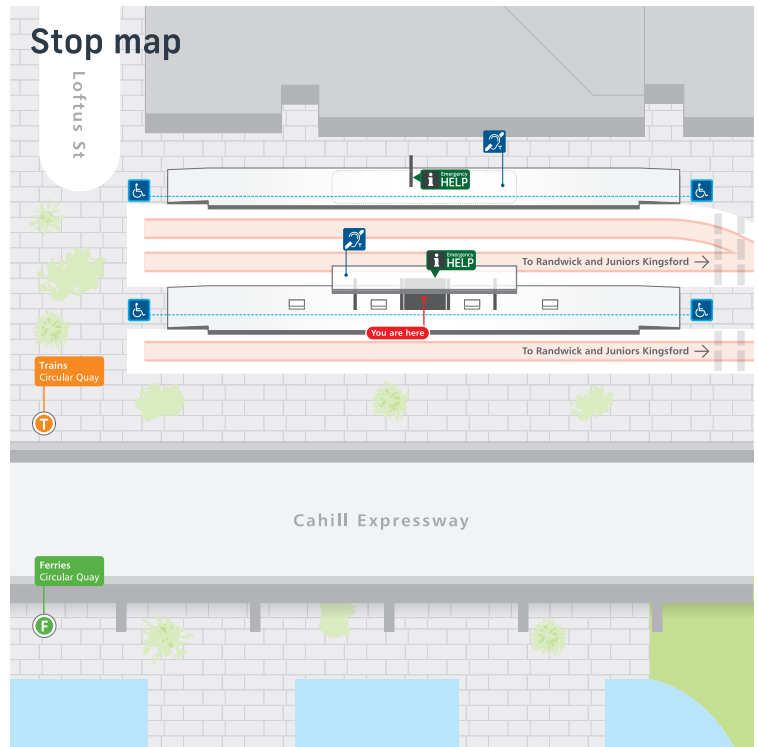

## Sydney light rail network

**L** Light Rail

### Sydney light rail lines

- L1** **Dulwich Hill Line**  
Dulwich Hill  
Central
- L2** **Randwick Line**  
Circular Quay  
Randwick
- L3** **Kingsford Line**  
Circular Quay  
Juniors Kingsford

